

## Push-Through Medium Bi-Pin Fluorescent Lamp Lampholders

### APPLICATION and PERFORMANCE SPECIFICATION

**Description:** T8/T12 Lampholder With Integrated Rotor for Shunted and Non-Shunted Applications

- Pin Support System for reliable lamp pin support
- Bottom push-in terminals: 18AWG
- For wall thickness 0.4mm - 2mm (0.016 - 0.079")
- 660W / 600V
- Shunted models compliant

| Type         | Ref. #        | Lamp Axis (mm) | Recommended Cut-Out (mm) | Internal Shunting | Stop       | Drawing  | Material      | Weight (g) | Packing Unit |
|--------------|---------------|----------------|--------------------------|-------------------|------------|----------|---------------|------------|--------------|
| 28700        | 109342        | 31             | 25.5 x 10.1              | -                 | yes        | A        | PC/PBT        | 7.8        | 1000         |
| 28725        | 109376        | 31             | 25.5 x 10.1              | Shunted           | yes        | A        | PC/PBT        | 7.8        | 1000         |
| 28701        | 109343        | 31             | 25.5 x 10.1              | -                 | no         | A        | PC/PBT        | 7.8        | 1000         |
| 28726        | 109377        | 31             | 25.5 x 10.1              | Shunted           | no         | A        | PC/PBT        | 7.8        | 1000         |
| <b>29100</b> | <b>109346</b> | <b>23</b>      | <b>25.5 x 9</b>          | <b>-</b>          | <b>yes</b> | <b>B</b> | <b>PC/PBT</b> | <b>6.6</b> | <b>1000</b>  |
| 29125        | 109371        | 23             | 25.5 x 9                 | Shunted           | yes        | B        | PBT           | 6.6        | 1000         |
| 29101        | 109529        | 23             | 25.5 x 9                 | -                 | no         | B        | PC/PBT        | 6.6        | 1000         |
| 29126        | 109372        | 23             | 25.5 x 9                 | Shunted           | no         | B        | PBT           | 6.6        | 1000         |
| 29300        | 509134        | 16             | 25.5 x 9                 | -                 | yes        | C        | PC/PBT        | 4.7        | 1000         |
| 29300        | 509136        | 16             | 25.5 x 9                 | Shunted           | yes        | C        | PBT           | 4.7        | 1000         |
| 29301        | 509135        | 16             | 25.5 x 9                 | -                 | no         | C        | PC/PBT        | 4.7        | 1000         |
| 29301        | 509137        | 16             | 25.5 x 9                 | Shunted           | no         | C        | PBT           | 4.7        | 1000         |

**Safety:**

- cUL<sub>US</sub> listed - Indoor Use (E110363)
- ENEC

**Performance:**

- Meets ANSI Standard C81.62-2009
- Meets IEC Standard 60400



**Warranty:**

Universal Lighting Technologies warrants to the purchaser that each lampholder will be free from defects in material or workmanship for a period of 3 years from date of manufacture when properly installed and under normal conditions of use. Call **1-800-BALLASTx800** for technical assistance.

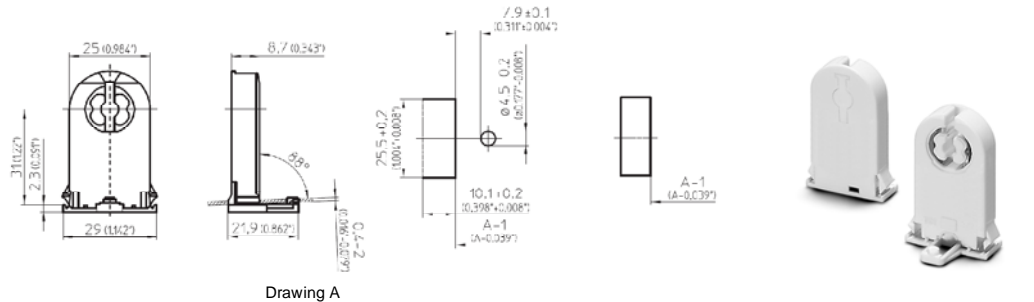

Drawing A

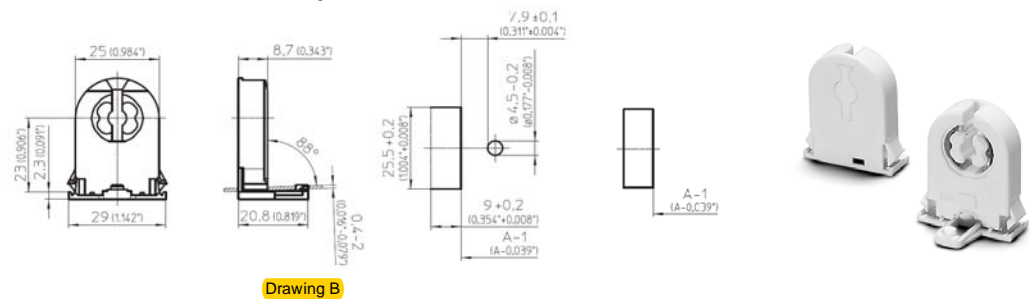

Drawing B

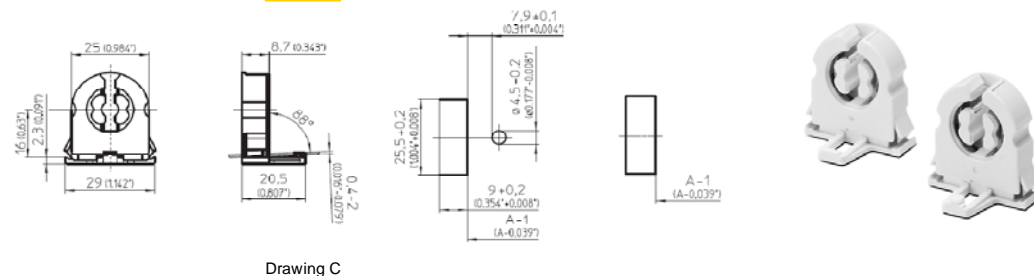

Drawing C