

Linear Fluorescents: General Applications

26.292.1112

G13 (Medium Bi-Pin): Push-Through Lampholders

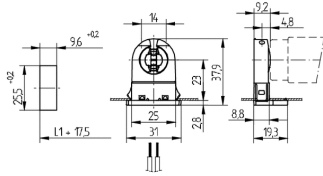

L1+17.5: Recommended cutout spacing . "L1" distance is determined by the length of the respective lamp.

color	pkg.	wt.	part no.
white	500	6 g	26.292.1112.50

Approval: cULus

Lamp center: 23 mm
Push through mount

Housing: PC
Rotor: PBT

- For enclosed cut-outs: 9.6 x 25.5 mm
- A pair of lampholders provides a lamp length tolerance compensation of 3 mm

T 130	Tm 110	U out 500 V							
-------	--------	----------------	--	--	--	--	--	--	--